

D *MID-TOUR 2013* **E P L O Y** *RECOUP RECHARGE RE-DEPLOY*

**"...everyone to whom much was given, of him much will be required..."
Luke 12:48**

October 6, 2013

Dear Cornerstone,

One year ago we launched the *Deploy Initiative*, a one-fund budget approach. Over the year, some adjustments have taken place, but the mission remains the same: to connect people to Jesus for transformed lives through the I Am Cornerstone model of *Bring-Invest-Give-Go*.

Financially we are close to the commitment target. By the calendar, we're 42% through the 2-years. By dollars given, we're 36% through the 2-year commitment. Definitely good numbers, but still 6% low, which represents over \$300,000.

The weekend of November 23-24 we will have a special *Mid-Tour Offering*. Please take this opportunity to get to 50% of your commitment. If you committed to make a one-time sacrificial gift, we urge you to use this weekend to fulfill your commitment. It will help tremendously with initial construction costs and the launch of our first multisite location.

We are excited that *Deploy* represents a multisite model along with building expansion at the Shiloh campus. Both of these aspects have exciting updates.

As we move forward, please feel welcome to contact either of us, as well as any of the Cornerstone elders, if you have any questions or concerns.



Scott Adkins
Lead Pastor of Direction



Ian Stamps
Lead Pastor of Teaching

D MID-TOUR 2013
DEPLOY
RECUP RECHARGE RE-DEPLOY

On December 1, 2012 we began the initiative to take our mission of Being Cornerstone to the next level. Our churchwide definitions of Bring-Invest-Give-Go are listed below along with the four missions of Deploy:

- BRING:** I bring my friends, family and neighbors into environments where Jesus can transform their life.
- Mission to BRING:** Deploy introduces ways to create increased square footage for ministry expansion
- INVEST:** I invest my life in those around me for the purpose of bringing them closer to Jesus
- Mission to INVEST:** Deploy provides expanded/remodeled connection space
- GIVE:** I give my time, skills, resources and money so others can be connected to Jesus.
- Mission to GIVE:** Deploy includes ministry operating expenses for 2013 and 2014
- GO:** I go into my neighborhood, my community and my world with the life-changing message of Jesus.
- Mission to GO:** Deploy continues Cornerstone's dedication to missions & benevolence

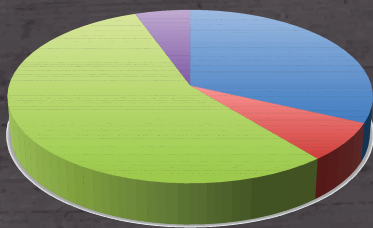

- Mission: We Bring
- Mission: We Invest
- Mission: We Give
- Mission: We Go

Where Are We?

5.2 Million 276 Commitments Received

Financially we are close to the commitment target. By the calendar, we're 42% through the 2-years. By dollars given, we're 36% through the 2-year commitment. Definitely good numbers, but still 6% low, which represents over \$300,000. At the end of November 2012, we began praying how to BRING the MOST people to Jesus using the commitments received. Because of your faithfulness we can continue to move forward with our mission.

Shiloh Campus

Weekend attendance is beginning to be over 1500. We added a fifth service in order to alleviate some of the crowding. With many of you choosing to Be Cornerstone and attend the Saturday evening services, we have room for visitors and new people to attend at the popular 9:45 and 11am Sunday services. We have had 61 baptisms so far this year.

We hope to break ground for the new children's wing in November 2013.

The additional Cornerstone Kids area accomplishes many of our goals. Centralized classrooms for nursery through grade 5 will be a huge help for parents and children. Additional classroom space will be added, including large group worship areas for preschool ages. This frees up classes in our existing space that can be utilized for other needs.

FIVE SERVICES

Saturday 5 & 6:15pm
Sunday 8:30, 9:45 & 11am



Multisite

Our first multisite campus has been identified. Because of the Deploy update videos, Pontoon Beach Christian Church caught a part of our vision. The elders of the congregation approached us about the possibility of joining with us to reach more people in the Pontoon Beach area. Through much prayer and discussion with our elders, we have determined that the potential of reaching people in the Pontoon Beach area for Christ is phenomenal. Cornerstone Pontoon Beach will become our first multisite campus.

Milestones of Deploy

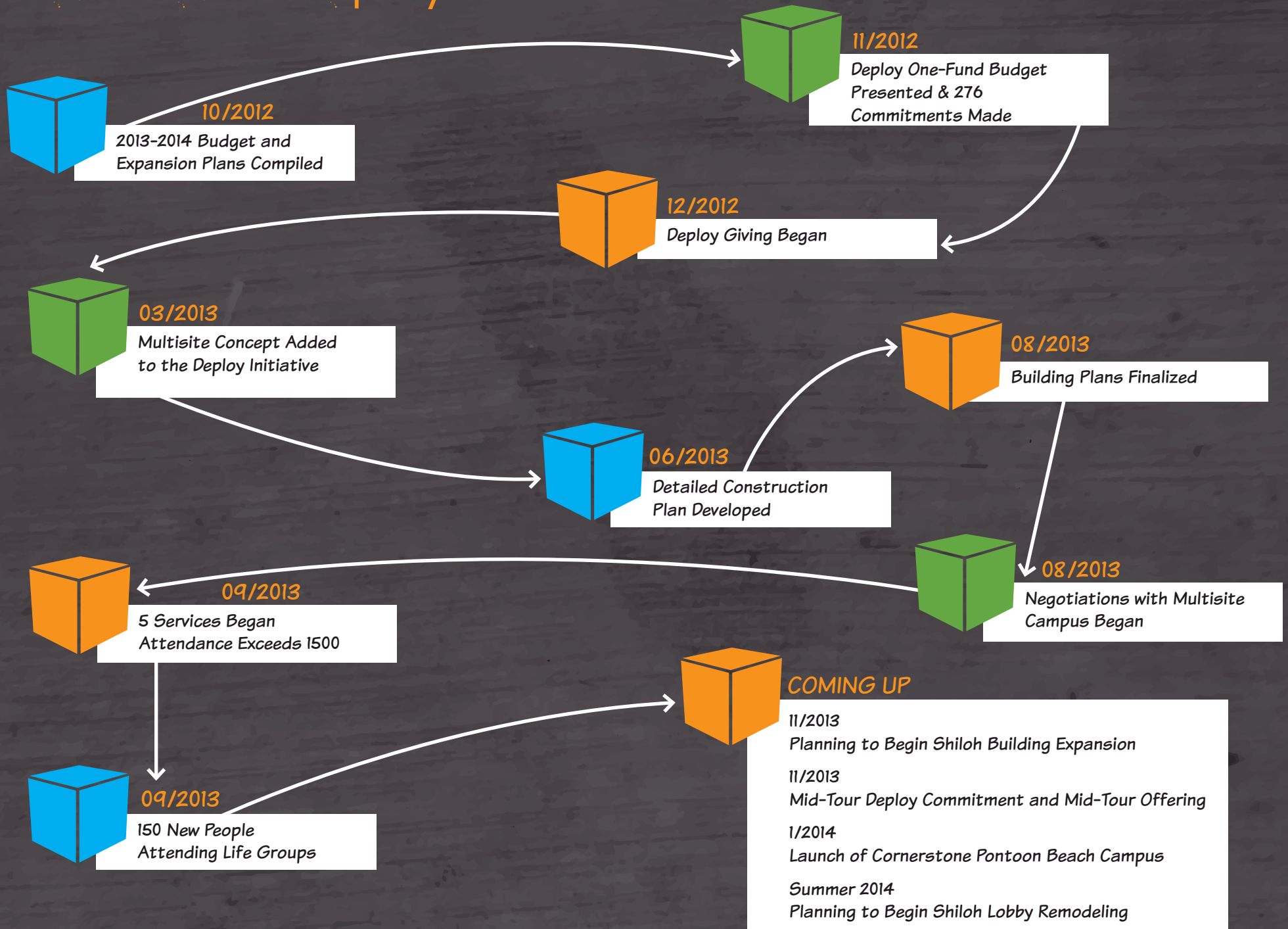

What's the Next Step?

Shiloh Campus

Phase 1 of the Shiloh Campus expansion is planned to begin in November 2013. Groundbreaking on the new Cornerstone Kids wing will help us celebrate the 1 year anniversary of the Deploy Initiative.

Phase 2 of the Shiloh Campus is planned for the Summer of 2014. This will include the renovation of the foyer area. The existing office area will become a cafe that will allow for more connection time during all the weekend services and throughout the week.

Cornerstone Students will also benefit from this phase with an update and redesign of their existing area.

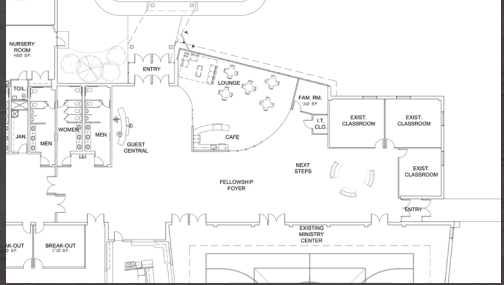

Multisite

The Pontoon Beach area has many opportunities for growth. The building is structurally sound but will need some updating and minor renovations. Through the new campus, Cornerstone's circle of influence will be expanded greatly. The multisite approach is a very cost-effective way to connect more people to Jesus for transformed lives.

Cornerstone Pontoon Beach will be most effective when a core group of our Shiloh people commit to serving there. Two of our elders have already agreed to make the Pontoon Beach campus their home church.

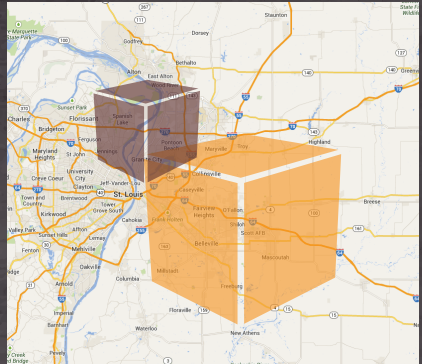

Prior to the first service at Cornerstone Pontoon Beach in January, we will offer many ways for you to be involved. The community will need to know what is going on and we will need your help to get the word out.



Remember the Coin?

We hope so. Keep your coin with you so you can remember to pray for Cornerstone through this time.

Here are some things you can pray for:

- Pray for Our Staff
- Pray for Our Elders
- Pray for Our Volunteers
- Pray for Our New Campus
- Pray for People Who Will Be Impacted by Cornerstone

Some coin ideas from others:

- Drill a hole in the coin & add it to your keychain.
- Slide the coin in your money clip.
- Keep the coin with your change purse.
- Make it into jewelry.

Do You Need a Coin?

If you came to Cornerstone in the last year, you have probably not received a coin. You can go to the office window and we would be happy to give you one.

What Can I Do?

While a smaller number of people will be needed at Cornerstone Pontoon Beach than our original multisite plan, we do need willing people to be committed to the new site. There are many opportunities for service and outreach into the community. We have something special at Cornerstone that we can share with the community of Pontoon Beach, but we need you to Be Cornerstone. Whether that is by following through on your original commitment or increasing that to another level, we ask that you pray about what God would have you do.

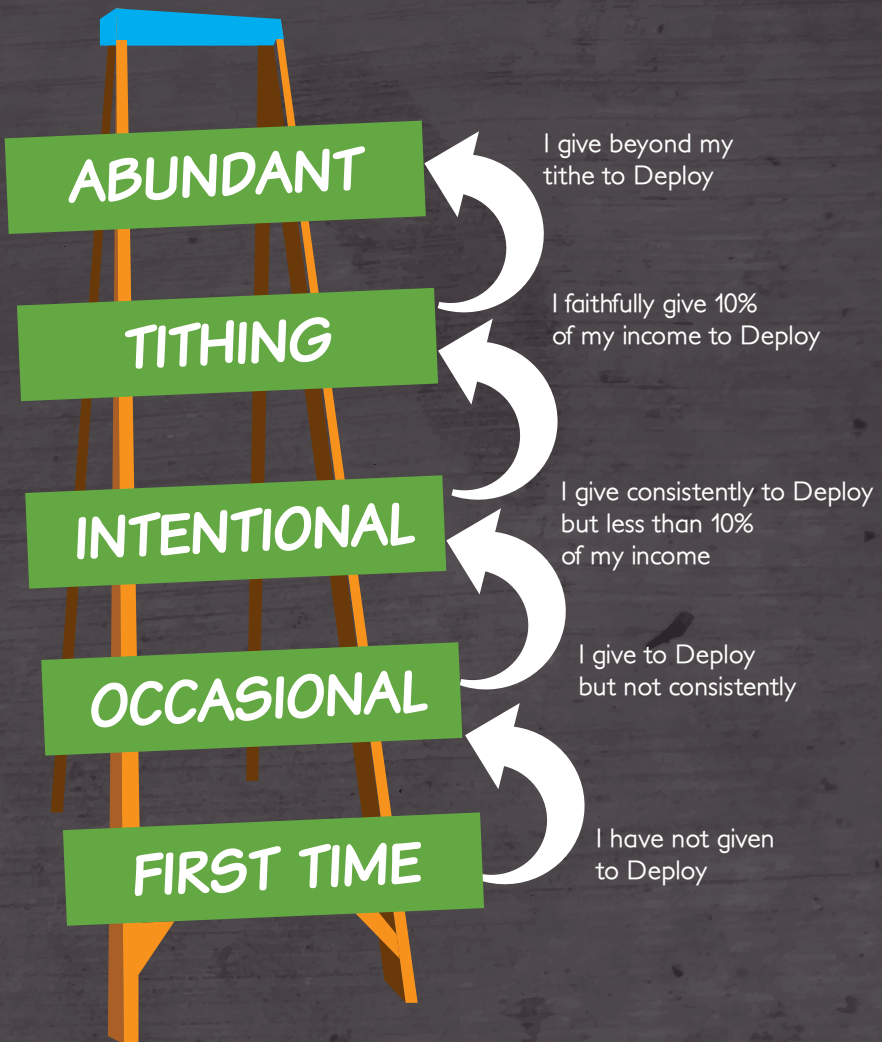

Your Commitment Card

The weekend of November 23-24 we will be collecting a special Mid-Tour Offering. Please take this opportunity to reach 50% of your commitment. If you planned to make a one-time sacrificial gift, we urge you to use this weekend to fulfill your commitment. It will help tremendously with the launch of Cornerstone Pontoon Beach and with initial construction costs.

Three Steps to Prepare

Step 1: Pray

This is the first and most important step in preparing your heart to respond to God's call to action. Ask Him what He would have you give to help others find the peace and promise you have found in Christ. Listen to what He says.

Step 2:

Prepare to do More

Allow God to expand your vision. He often enables us to do more than we thought possible. God is the true source of the "think big" idea.

Step 3:

Expect God's Blessing

Leave room for faith in setting your goal. Prepare to experience great satisfaction and contentment knowing you have faithfully responded to God's prompting.

DEPLOY

MID-TOUR 2013
RECOUP RECHARGE RE-DEPLOY

This is my **FIRST** Deploy commitment.

Over the next 12 months I am making a sacrificial commitment through my generosity in the amount of:

\$ _____

I have already made a commitment.

Over the next 12 months I plan to:

- Confirm my commitment and finish strong
- Increase my Deploy Commitment to:

\$ _____

I want to "Be Cornerstone" in Pontoon Beach.

I will attend at Pontoon Beach

I will help serve at Pontoon Beach

I will help prepare Pontoon Beach (Remodeling, Saturday Community Days)

Name: _____

Phone: _____

Email: _____

Address: _____

Frequently Asked Questions

How will my moving to the new site help Cornerstone?

Current members "get" what Cornerstone is all about. You already follow the I Am Cornerstone model of Bring-Invest-Give-Go. When a multisite is in your local community, you become the church leaders and nucleus, taking Cornerstone "DNA" to another building. By relocating, you also immediately create open seating in Shiloh. Having a multisite allows us to reach an even further geographic area than we have now. There will be some who are willing to drive extra for the large church experience. However, the experience at a multisite location will be very similar to what is available in Shiloh. Having a more local building to attend also makes it more appealing to invite your neighbors and makes it easier to impact and care for your local community.

Why change the original Deploy plans?

Our mission of connecting people to Jesus remains intact. This redefined plan of expanding Cornerstone's reach extends much further with the multisite model. It makes it easier for our church members to be involved in their communities and neighborhoods and easier to invite others to join them.

How is a multisite different from a church plant?

The goal of a church plant is that the church will eventually have a separate life of its own and be able to minister and function without using the resources of a larger church. A multisite church is the same church that meets in multiple locations. We are simply expanding to another area.

What will a Worship Service look like at another campus?

Each site will have a live band and a local Worship Leader. Music worship will be as similar to what is in Shiloh as possible. There will be a Campus Pastor who knows members and is active in the local community. This person will speak from the stage during communion, offering, a welcome time, and possibly other times. Part of the Cornerstone experience that draws people is the message that is delivered by Ian Stamps. This message will be presented on a large screen in the center of the stage.

But I like being a large church.

Cornerstone in Shiloh will continue to be a building that accommodates over 1,000 people on the weekend and is an option for anyone to attend.

There won't be a mandate to attend the location nearest you. Where you attend is your choice.

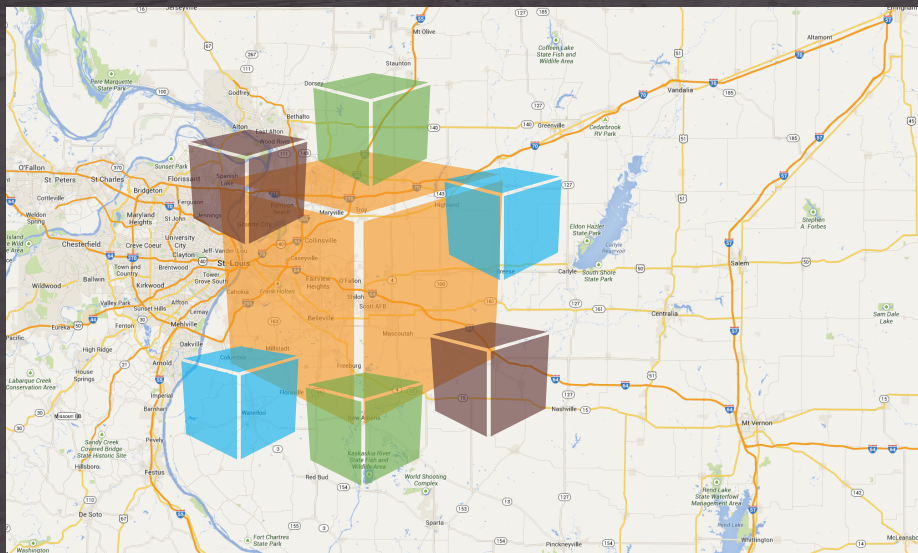

How will this connect more people to Jesus?

The Multisite option expands our reach geographically. There are people who prefer a large church atmosphere and others who prefer small church atmosphere. The Multisite model creates both options.

Will multisite locations offer the same programming for children & students?

The goal will be to have everything that is available in Shiloh, available at a multisite campus. There may be some local events that take place, such as community service projects. There will be some combined campus activities for grades 6-12.

When will Cornerstone Pontoon Beach start?

We will hold the first service January 12, 2014. Outreach opportunities are being planned for December. Details coming soon.

What will the staffing look like at Cornerstone Pontoon Beach?

Cornerstone Pontoon Beach will have a full-time Campus Minister who lives in the area and is involved in the community. Other part-time positions for worship, children, and students will be added as needed.

Where will my tithes and offering go? (Site based or central office)

Accounting and finance are areas that produce a cost benefit by utilizing shared resources. All money will be handled centrally.

Is multisite more cost effective than a megachurch model?

Depending on building rental or ownership, costs will vary. However, when you look at how the multisite option expands Cornerstone's reach, the people to dollar effectiveness is much greater.

Why is this the right time to pursue multisite?

The concept and acceptance of multisite has been growing over the last 20 years and has exploded in the last 2-3 years. Research shows the following figures:

- In 1990, there were 10 multisite churches.
- In 1998, that number had expanded to about 100.
- In late 2005, there were more than 1,500 multisite churches in the United States.
- In 2008, there were an estimated 2,000 multisite churches across the United States.
- In 2012 there were over 5,000 multisite churches across the United States.

Are other churches in our area using the multisite concept?

Multisite campuses are being offered across the St. Louis area and in the Metro East.

- The Journey Fellowship: O'Fallon IL, Marion, Illinois, St. Louis (2), Manchester, Clayton
- Christ Church: Fairview Heights, Collinsville, Millstadt
- Harvester Christian Church: St. Charles, Troy, Missouri.

COMING UP

MID-TOUR OFFERING
NOVEMBER 23 & 24

MID-TOUR CELEBRATION
DECEMBER 7 & 8



cornerstone
christian church
connecting people to Jesus

775 n green mount rd. shiloh, il 62221 cornerstoneshiloh.org